

PARALLEL CLAMPS

Cable to Cable

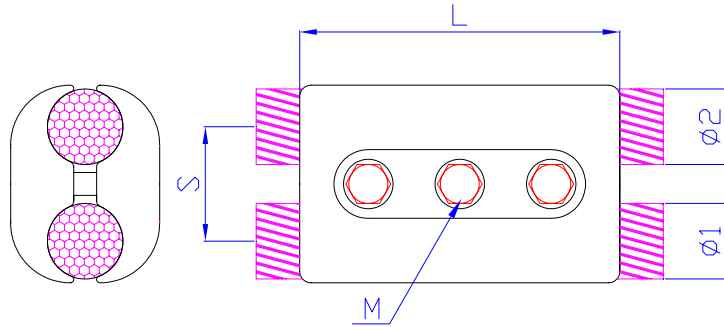

Catalogue Number	Conductor Range (mm)		Dimensions (mm)		
	($\phi 1$)	($\phi 2$)	S	L	M
PC-1919	12-19	12-19	50	135	10
PC-1927		19-27	50	135	10
PC-1933		26-33	50	135	10
PC-1942		36-42	60	135	10
PC-2719	19-27	12-19	50	135	10
PC-2727		19-27	50	135	10
PC-2733		26-33	50	135	10
PC-2742		36-42	60	135	10
PC-3319	26-33	12-19	50	135	10
PC-3327		19-27	50	135	10
PC-3333		26-33	50	135	10
PC-3342		36-42	60	135	10
PC-4219	36-42	12-19	50	135	10
PC-4227		19-27	50	135	10
PC-4233		26-33	50	135	10
PC-4242		36-42	60	135	10

PARALLEL CLAMPS

Tube to Cable

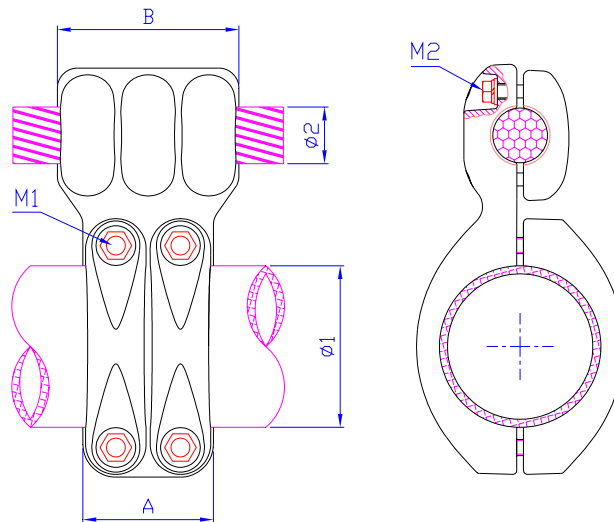

Catalogue Number	Conductor Range (mm)		Dimensions (mm)			
	($\phi 1$)	($\phi 2$)	A	B	M1	M2
PC2-5019	50	12-19	93	77	12	10
PC2-5027		19-27	93	77	12	10
PC2-5033		26-33	93	77	12	10
PC2-5042		36-42	93	77	12	10
PC2-6019	60	12-19	93	77	12	10
PC2-6027		19-27	93	77	12	10
PC2-6033		26-33	93	77	12	10
PC2-6042		36-42	93	77	12	10
PC2-8019	80	12-19	93	77	12	10
PC2-8027		19-27	93	77	12	10
PC2-8033		26-33	93	77	12	10
PC2-8042		36-42	93	77	12	10
PC2-1019	100	12-19	93	77	12	10
PC2-1027		19-27	93	77	12	10
PC2-1033		26-33	93	77	12	10
PC2-1042		36-42	93	77	12	10
PC2-1219	120	12-19	93	77	12	10
PC2-1227		19-27	93	77	12	10
PC2-1233		26-33	93	77	12	10
PC2-1242		36-42	93	77	12	10

Continued on next page

PARALLEL CLAMPS

Tube to Cable

Continued

Catalogue Number	Conductor Range (mm)		Dimensions (mm)			
	Tube($\phi 1$)	Cable($\phi 2$)	A	B	M1	M2
PC2-1619	160	12-19	103	77	12	10
PC2-1627		19-27	103	77	12	10
PC2-1633		26-33	103	77	12	10
PC2-1642		36-42	103	77	12	10
PC2-2019	200	12-19	127	77	14	10
PC2-2027		19-27	127	77	14	10
PC2-2033		26-33	127	77	14	10
PC2-2042		36-42	127	77	14	10
PC2-2519	250	12-19	127	77	14	10
PC2-2527		19-27	127	77	14	10
PC2-2533		26-33	127	77	14	10
PC2-2542		36-42	127	77	14	10

Triple PARALLEL CLAMPS

Three Cable

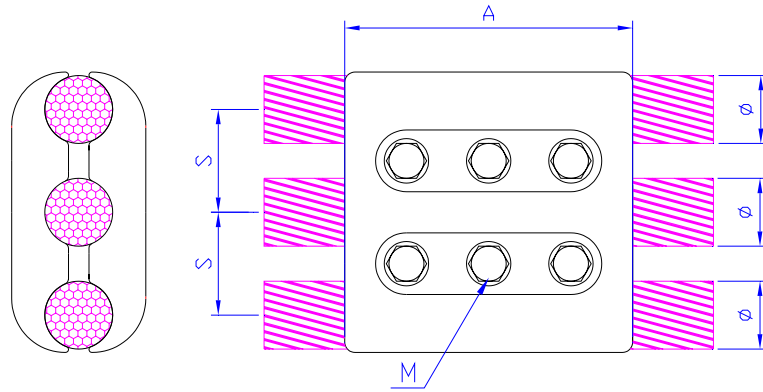

Catalogue Number	Conductor Range (mm) (ϕ)	Dimensions (mm)		
		A	S	M
PC3-1919	12-19	135	50	10
PC3-2727	19-27	135	50	10
PC3-3333	26-33	135	50	10
PC3-4242	36-42	135	60	10

SINGLE DUPLEX PARALLEL CLAMPS

Tube to two Cable

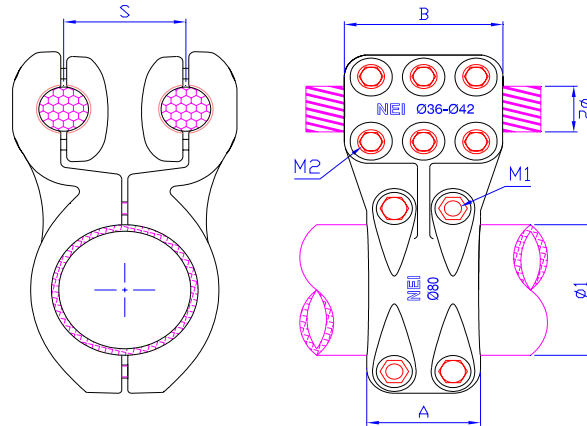

Catalogue Number	Conductor Range (mm)		Dimensions (mm)			
	($\phi 1$)	($\phi 2$)	A	B	M1	M2
PC22-5019	50	12-19	93	77	12	10
PC22-5027		19-27	93	77	12	10
PC22-5033		26-33	93	77	12	10
PC22-5042		36-42	93	77	12	10
PC22-6019	60	12-19	93	77	12	10
PC22-6027		19-27	93	77	12	10
PC22-6033		26-33	93	77	12	10
PC22-6042		36-42	93	77	12	10
PC22-8019	80	12-19	93	77	12	10
PC22-8027		19-27	93	77	12	10
PC22-8033		26-33	93	77	12	10
PC22-8042		36-42	93	77	12	10
PC22-1019	100	12-19	93	77	12	10
PC22-1027		19-27	93	77	12	10
PC22-1033		26-33	93	77	12	10
PC22-1042		36-42	93	77	12	10
PC22-1219	120	12-19	93	77	12	10
PC22-1227		19-27	93	77	12	10
PC22-1233		26-33	93	77	12	10
PC22-1242		36-42	93	77	12	10

Continued on next page

SINGLE DUPLEX PARALLEL CLAMPS

Tube to two Cable

Continued

Catalogue Number	Conductor Range (mm)		Dimensions (mm)			
	Tube(ϕ 1)	Cable(ϕ 2)	A	B	M1	M2
PC22-1619	160	12-19	103	77	12	10
PC22-1627		19-27	103	77	12	10
PC22-1633		26-33	103	77	12	10
PC22-1642		36-42	103	77	12	10
PC22-2019	200	12-19	127	77	14	10
PC22-2027		19-27	127	77	14	10
PC22-2033		26-33	127	77	14	10
PC22-2042		36-42	127	77	14	10
PC22-2519	250	12-19	127	77	14	10
PC22-2527		19-27	127	77	14	10
PC22-2533		26-33	127	77	14	10
PC22-2542		36-42	127	77	14	10